



Green-GO

DIGITAL INTERCOM

2019

- 4 Green-GO Communication**
- 5 BPX Wired Beltpack**
- 6 BPXSP Sport Beltpack**
- 7 WBPX Wireless DECT Beltpack**
- 8 WAA Antenna**
- 9 BC6 6-Way Battery Charger**
- 10 MCX 32 Channel Rack Station**
- 12 MCXD 32 Channel Desk Station**
- 14 RDX Walkie-Talkie Interface**
- 15 WPX Wall Stations**
- 16 BEACON Light Signals**
- 17 INTERFACEX Audio-Interface**
- 18 QUAD 4-Wire Interface**
- 19 DANTE Interface**
- 20 SI2 & SI4 Slim Audio Interfaces**
- 22 BRIDGEX Interface**
- 23 GBx Switch**
- 24 SW8.1 & SW5 Switch**
- 25 Green-GO Configuration Software**



Digital Intercom

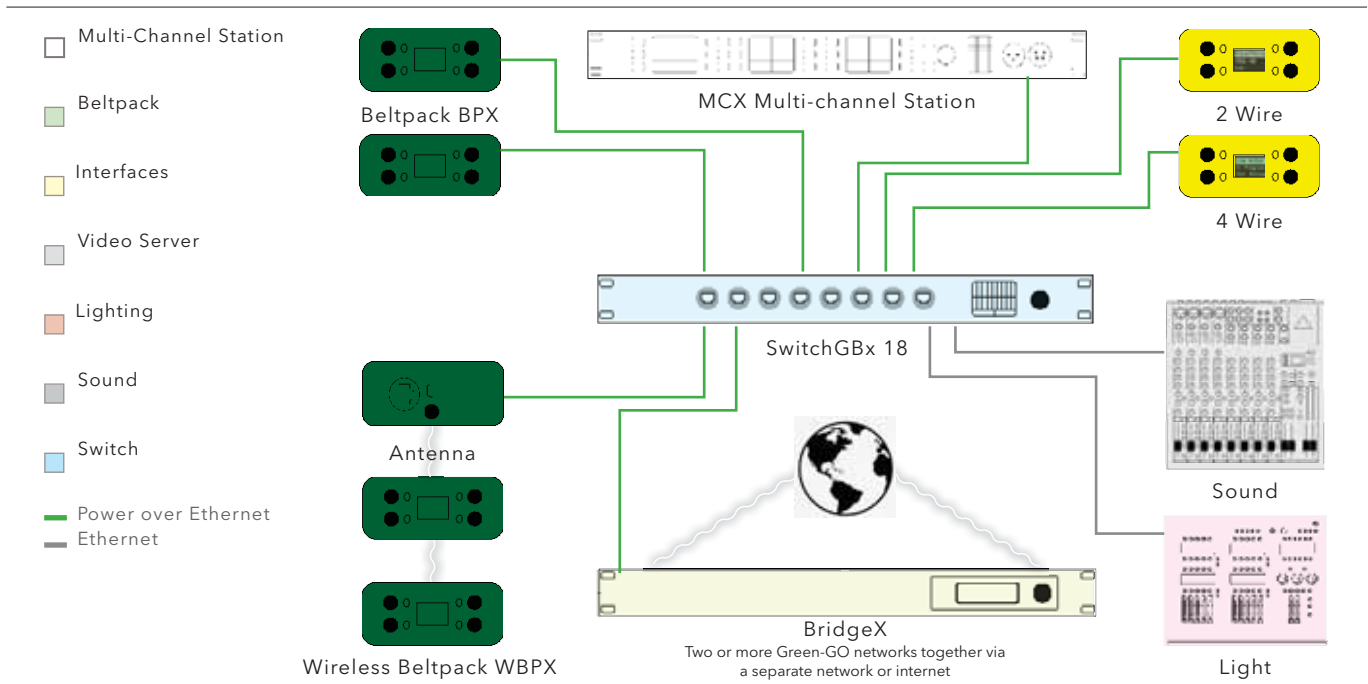

Most intercom and light-signal systems currently used in theaters, opera houses and concerts rely on independent networks or dedicated data networks, often with complex and expensive central processing units.

Green-GO is a completely new communication system that can easily be connected to almost any existing Ethernet network. The Green-GO system combines digital voice communication with light signals / cuelight and text messages. It achieves this through compact beltpacks, wall stations, desk and rack stations. All devices can be supplied with power via the Ethernet connections and thus operated with Power over Ethernet on any network. Once set up, connected components store all data locally, eliminating the need for a costly centralised matrix.

Users can talk to groups (up to 250) and/or directly to other users (up to 3000). Audio signals can be easily looped into a system, sent to a group and retrieved by any user, if and when required. Non-verbal communication functions, such as red and green light signals, confirmation of waiting signals and text messages can also be transmitted to groups or direct users.

All devices share the same characteristics. Each has 32 channels, a program audio channel and an announce channel, an emergency channel, and extra channel for direct user communication.

All settings and various configurations can be prepared and saved using the free Green-GO Control software. The smallest conceivable network for a Green-GO system consists of only two beltpacks and one standard PoE switch. Green-GO systems can be enlarged or reduced at any time by simply connecting and removing additional components.

PoE

Power over Ethernet allowing a single cable to provide both data connection and electric power.

32 Channels

This system has 32 channels, a program audio channel and an extra channel to receive direct user communication.

250 Groups

An analogue system has one or two groups, the Green-GO system offers a maximum of 250 groups.

3000 Users

A user can be active on any device, even on multiple devices. Each user has a unique ID and a human readable name.

Private Talk

When programmed as a Direct User it enables a private direct conversation between users.

Digital Audio

Specially equipped with a high-quality sound card and processing digital audio at a professional level.

BPX Wired Beltpack



The BPX Beltpack is a lightweight and durable companion Ethernet network based digital intercom system, providing comfortable and direct access to up to 4 direct Channels. The 4 buttons can be used either all be used as talk buttons, or as a combination of talk and call buttons (in the combination 2/2 or 3/1). A simple press of the button will toggle (latch), while a long press will temporarily activate the voice connection (PTT). A simple key combination enables the user to enter the extended Channel mode, where there's access to all 32 available channels.

A high-contrast OLED display can provide text messages, light and call signs, as well as status messages clearly in any environment. Incoming call signals are indicated by a red/white flashing display, while alarm signals can additionally activate an alarm tone if desired. Two multi-purpose encoders on the sides of the unit complete the hardware features, providing multiple functions including volume control. All settings can be made either on the device itself via the integrated display or via the free Green-GO Control Software.

Technical Data

- Dimension: 95mm x 119mm x 42mm
- Weight: 260 g
- Connections: 1 x Neutrik XLR4M, 1 x 10/100Mbps Neutrik RJ45 etherCON
- Controls: 1 x OLED colour display, 4 Buttons, 2 x Multifunction-Encoders
- Power Supply: PoE (802.3af)

Article Reference

GGO-BPX

Accessory

GHSA05



GHSA05 Handset Telephone Style



BPXSP Sport Wired Beltpack



The BPXSP beltpack was developed for use outdoors, utilizing a backlit LCD display for easier viewing in sunlight, and larger, weather-tight buttons for protection from wet conditions and use with gloves. It's a lightweight and durable companion Ethernet network based digital intercom system, providing comfortable and direct access to up to 4 direct channels. The 4 big buttons can be used either all be used as talk buttons, or as a combination of talk and call buttons (in the combination 2/2 or 3/1). A simple press of the button will toggle (latch), while a long press will temporarily activate the voice connection (PTT). A simple key combination enables the user to enter the extended Channel mode, where there's access to all 32 available channels.

The LCD can display text messages, light and call signs, as well as status messages clearly in any environment. Incoming call signals are indicated by a red/white flashing display, while alarm signals can additionally activate an alarm tone if desired. Two multi-purpose encoders on the sides of the unit complete the hardware features, providing multiple functions including volume control. All settings can be made either on the device itself via the integrated display or via the free Green-GO Control Software.

Technical Data

- Dimension: 95mm x 119mm x 49mm
- Weight: 260 g
- Connections: 1 x Neutrik XLR4M, 1 x 10/100Mbps Neutrik RJ45 etherCON
- Controls: 1 x OLED colour display, 4 Buttons, 2 x Multifunction-Encoders
- Power Supply: PoE (802.3af)

Article Reference

GGO-BPXSP

Accessory

GHSA05 Telephone Style



WPBX Wireless DECT Beltpack

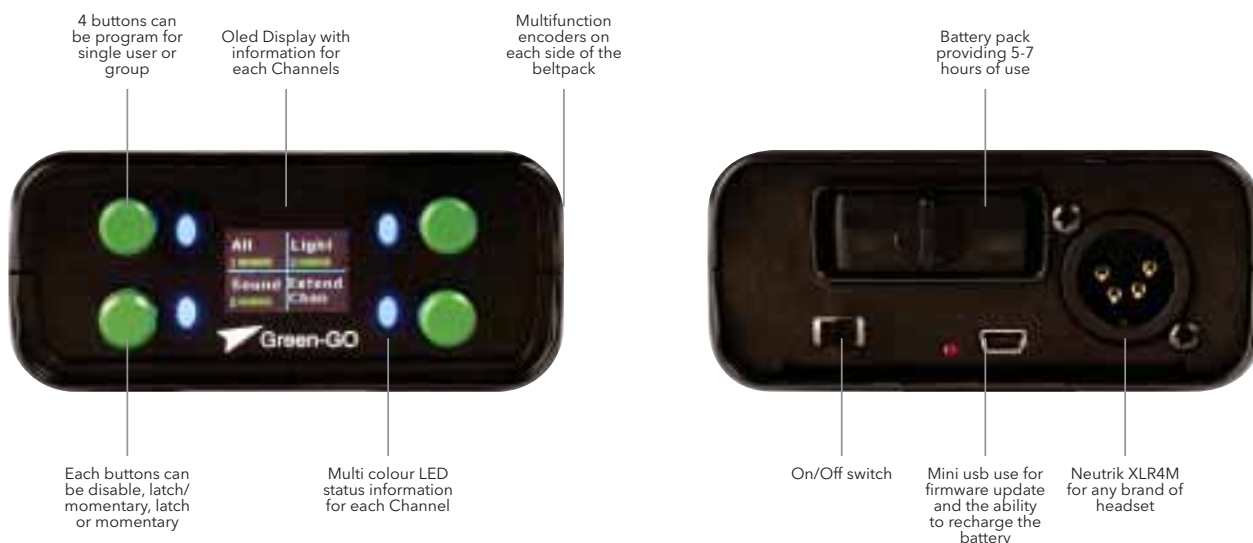

The WPBX Wireless Beltpack uses DECT wireless technology to communicate with the WAA antenna, providing the same features and flexibility that you're already familiar with from the Green-GO wired system. This allows for users to seamlessly switch from wired to wireless without having to learn a new system. Each WPBX Wireless Beltpack can be paired with up to four WAA antennas to extend the range as required.

The WPBX Wireless Beltpack provides direct access to up to 4 Channels. The 4 buttons can be used either all be used as talk buttons, or as a combination of talk and call buttons (in the combination 2/2 or 3/1). A simple press of the button will toggle (Latch), while a long press will temporarily activate the voice connection (PTT). A simple key combination enables the user to enter the extended Channel mode, where there's access to all 32 available Channels.

A high-contrast OLED display displays text messages, light and call signs as well as status messages clearly in any environment. Incoming call signals are indicated by a red/white flashing display, while alarm signals can additionally activate an alarm tone if desired. Two multi-function encoders on the sides of the unit complete the hardware features, providing multiple functions including volume control. All settings can be made either on the device itself via the integrated display or via the free Green-GO Control Software.

The WPBX Wireless Beltpack comes with a battery life of 5-7 hours and can be operated or charged via the mini usb port. A separate charging station is not mandatory.

Technical Data

- Dimension: 95mm x 119mm x 42mm
- Weight: 345 g with battery 300 with-out
- Connections: 1 x Neutrik XLR4M, 1 x Mini usb
- Controls: 1 x OLED colour Display, 4 Buttons, 2 x Multi-Function Encoders, On/Off switch, LED Status Indicator
- Power Supply: 1800mAh Lithium-Ion Battery Pack

Article Reference

GGO-WBPX
NRGP Battery

Accessory

GHSA05 Telephone Style



WAA Wireless Antenna



The Green-GO Wireless Antenna is part of the Green-GO wireless communication system and is based on DECT technology. One Wireless Antenna serves up to four Wireless Beltpacks and each Wireless Beltpack X can be connected to four Wireless Antennas. The Green-GO Wireless Antenna can also integrate the Wireless Beltpack X into an existing wired network by simply plugging in the Wireless Antenna and cloning the configuration to the Wireless Beltpack(s).

The Wireless Antenna is powered through either the Power over Ethernet port or the mini usb connector, both of which are located on the back of the device.

Technical Data

- Dimension: 95mm x 119mm x 42mm
- Weight: 220 g
- Connections: 1 x 10/100Mbps Neutrik RJ45 EtherCON, 1 x Mini usb
- Controls: 1 x Button, 1 x LED Status Indicator
- Power Supply: PoE (802.3af)
- 3/8 Ww thread for pole mounting

Article Reference

GGO-WAA

BC6 6-Way Battery Charger



The BC6 19" Rack charger can charge up to six NRGP batteries for WPBX Wireless Beltpacks. The LED Status Indicator informs the user whether a battery is still charging or is already fully charged.

Technical Data

- Dimensions: 485 x 110 x 45 mm
- Weight: 2.25 kg
- Power Supply: External 12V DC Adapter (Included)

Article Reference

GGO-BC6

MCX Multi-Channel Station

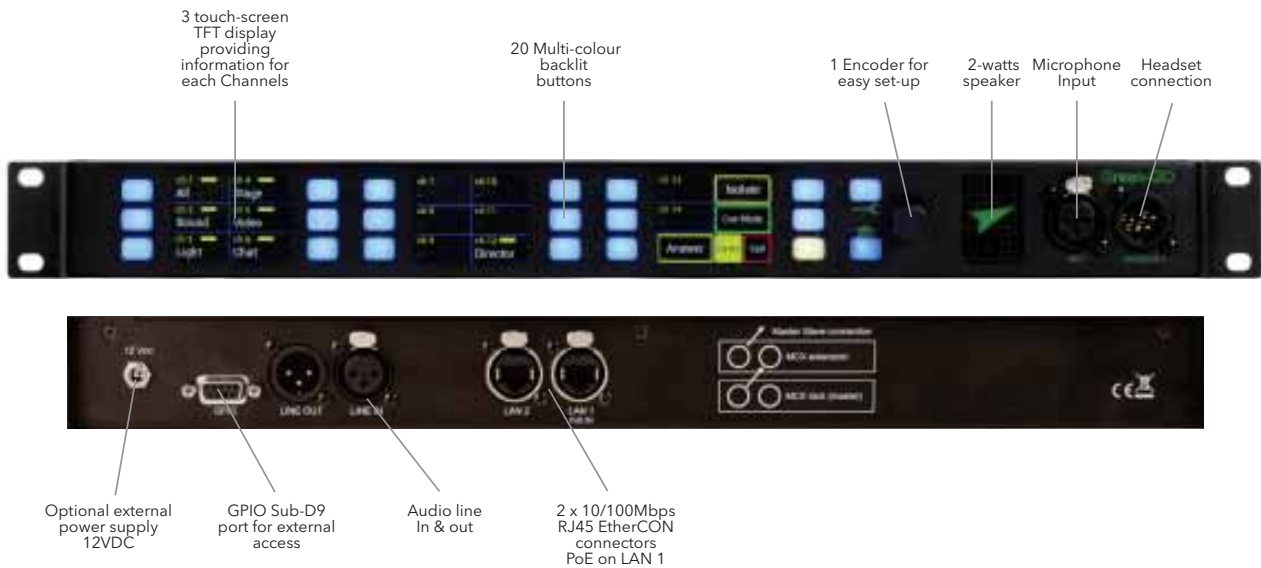

Due to its compact design, the 32 Channel MCX Rack integrates easily into any system. It offers the user direct access to up to 18 Channels or functions. On a second level, extended access is given to up to 32 Channels and 4 functions.

Three high-contrast colour touch-screen and 20 back-lit buttons allow for compact and precise operation, for speech, call or light signals.

The vast selection of connections offer a variety of possibilities. The user can communicate either through the built-in 2-watt speaker and an external microphone, or via a headset. In addition, it is possible to operate an external loudspeaker via the Line-Out connection, something which is particularly useful in noisy environments. External audio signals can easily be routed through the line-in port to all Green-GO subscribers via groups, for example a program audio.

The GPIO port allows external access to functions like talk or call of the Green-GO engine (light, ring and voice) via two inputs and two outputs for each.

Features

- MCX station can be extended with up to 9 Multi-Channel Extension slave devices
- Powered via PoE (802.3af-2003 Standard) or separate DC power supply
- Includes 2 EtherCON LAN sockets with 100MBit switch
- Intercom routing data, system setup & preferences are stored in local memory
- Create your own configuration with the free Green-GO Control software

Technical Data

- Dimensions: 485 x 110 x 45 mm
- Weight: 1.74 kg
- Connections (Neutrik): 1 x XLR4M, 2 x XLR3F, 1 x XLR3M, 2 x RJ45 etherCON, 1 x Sub-D9, 1 x 12V DC
- Controls : 3 x Colour-TFT Touch-screen, 20 Backlit Buttons, 1 x Encoder
- Power Supply: PoE (802.3af) or optional 12V DC

Accessory

- GNM430 Microphone (430mm)
- GNM300 Microphone (300mm)



GNM430 Microphone

MCX Multi-Channel Extension

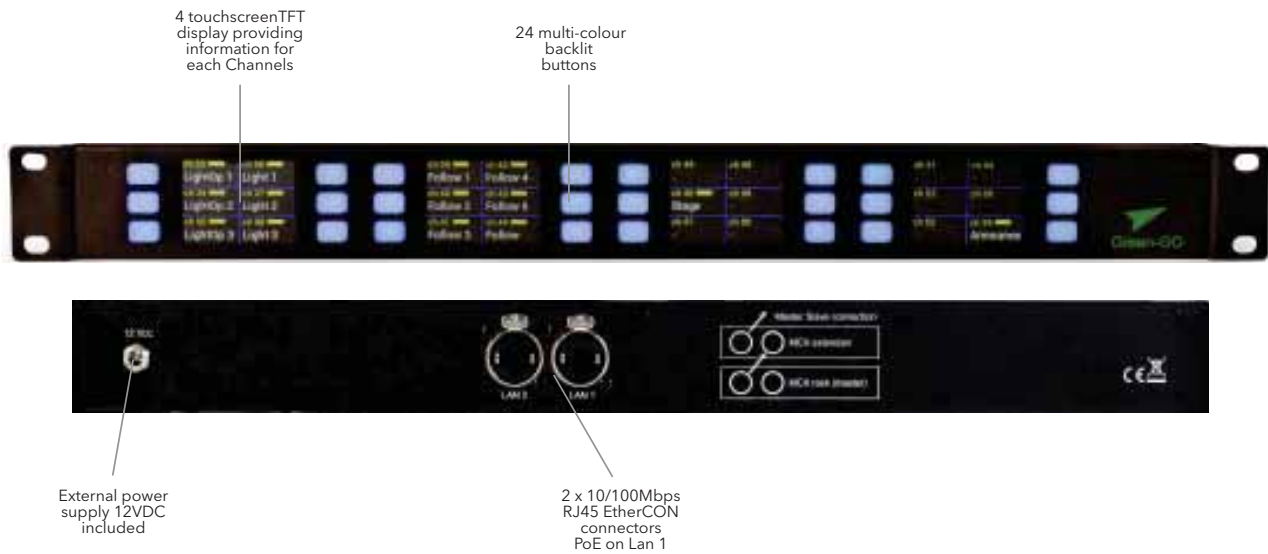

Green-Go MCXEXT Rack Channel extensions, providing flexibility for particularly large and complex systems, giving access to up to 248 Channels. Each extension provides direct access to 24 additional Channels. Functions and modes are always controlled from the MCX master station. The Channels of the MCXEXT extension can be assigned to groups or users.

The MCXEXT are daisy-chained via the second etherCON network port on the MCX Master Station and are powered by a 12V/1.8a external power supply.

Features

- Powered via DC power supply
- Includes 2 EtherCON LAN sockets with 100MBit switch
- Intercom routing data, system setup & preferences are stored in local memory
- Create your own configuration with the free Green-GO Control software

Technical Data

- Dimensions: 485 x 110 x 45 mm
- Weight: 1.67 kg
- Connections: 2 x 10/100Mbps Neutrik RJ45 EtherCON,
- Controls: 4 x Colour-TFT Touchscreen, 24 Backlit Buttons,
- Power Supply: External 12V DC (Included)

Article Reference

MCXEXT Rack Extension

MCXD Multi-Channel Station

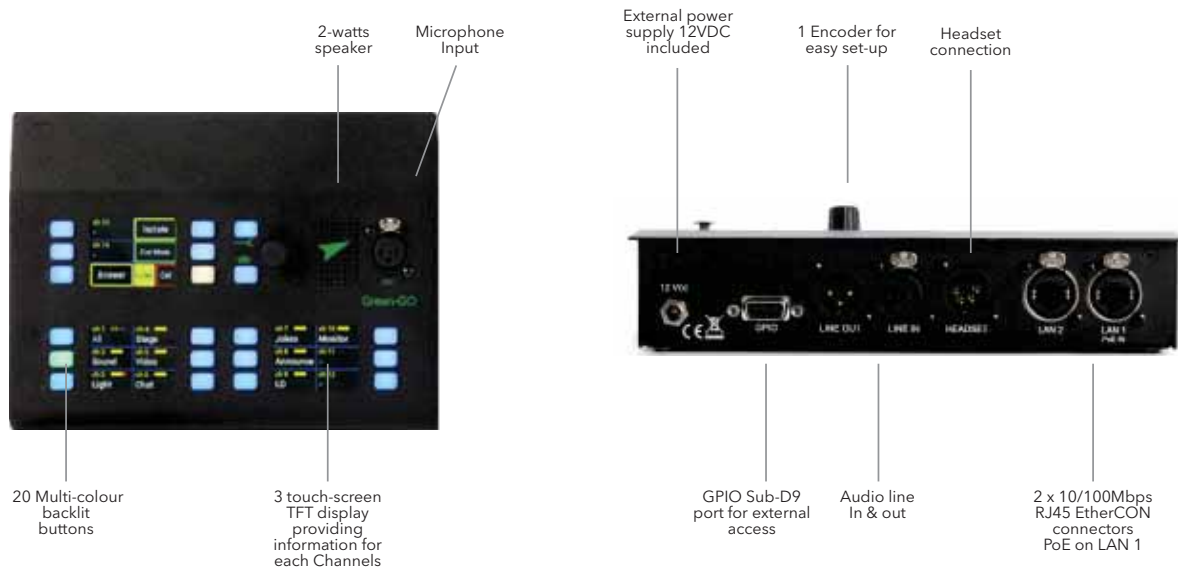

Due to its compact design, the 32 Channel MCXD Desk integrates easily into any system. It offers the user direct access to up to 18 Channels or functions. On a second level, extended access is given to up to 32 Channels and 4 functions.

Three high-contrast colour touch-screen and 20 back-lit buttons allow for compact and precise operation, for speech, call or light signals.

The vast selection of connections offer a variety of possibilities. The user can communicate either through the built-in 2-watt speaker and an external microphone, or via a headset. In addition, it is possible to operate an external loudspeaker via the Line-Out connection, something which is particularly useful in noisy environments. External audio signals can easily be routed through the line-in port to all Green-GO subscribers via groups, for example a program audio.

The GPIO port allows external access to functions like talk or call of the Green-GO engine (light, ring and voice) via two inputs and two outputs for each.



GNM430 Microphone

Features

- MCXD station can be extended with up to 9 Multi-Channel Extension slave devices
- Powered via PoE (802.3af-2003 Standard) or separate DC power supply
- Includes 2 EtherCON LAN sockets with 100MBit switch
- Intercom routing data, system setup & preferences are stored in local memory
- Create your own configuration with the free Green-GO Control software

Technical Data

- Dimensions: 220 x 160 x 45 mm
- Weight: 1.11 kg
- Connections (Neutrik): 1 x XLR4M, 2 x XLR3F, 1 x XLR3M, 2 x RJ45 etherCON, 1 x Sub-D9, 1 x 12V DC
- Controls : 3 x Colour-TFT Touch-screen, 20 Backlit Buttons, 1 x Encoder
- Power Supply: PoE (802.3af) or optional 12V DC

Article Reference

MCXD

Accessory

- GNM430 Microphone (430mm)
- GNM300 Microphone (300mm)

MCXD Multi-Channel Extension



24 Multi-colour
backlit
buttons

4 touch-screen
TFT display
providing
information for
each Channels



External power
supply 12VDC
included

2 x 10/100Mbps
RJ45 EtherCON
connectors
PoE on LAN 1

Green-Go MCXDEXT Desk Channel extensions, providing flexibility for particularly large and complex systems, giving access to up to 248 Channels. Each extension provides direct access to 24 additional channels. Functions and modes are always controlled from the MCX master station. The Channels of the MCXDEXT extension can be assigned to groups or users.

The MCXDEXT are daisy-chained via the second etherCON network port on the MCXD Master Station and are powered by a 12V/1.8a external power supply.

Features

- Powered via DC power supply
- Includes 2 EtherCON LAN sockets with 100MBit switch
- Intercom routing data, system setup & preferences are stored in local memory
- Create your own configuration with the free Green-GO Control software

Technical Data

- Dimensions: 220 x 160 x 45 mm
- Weight: 1.10 kg
- Connections: 2 x 10/100Mbps Neutrik RJ45 EtherCON,
- Controls: 4 x Colour-TFT Touch-screen, 24 Backlit Buttons,
- Power Supply: External 12V DC (Included).

Article Reference

MCXDEXT

RDX Walkie-Talkie Interface



The RDX walkie-talkie interface makes it possible to integrate a speech channel via radio into the Green-GO system, with push-to-talk support.

The radio channel is connected to the SUB-D9 connector of the RDX walkie-talkie interface, via the radio's headset (razor) port. This cable must be assembled as required to connect with the desired walkie-talkie system.

Technical Data

- Dimension: 95mm x 119mm x 42mm
- Weight: 245g
- Connections: 1 x 10/100Mbps Neutrik RJ45 EtherCON, 1 x SUB-D9,
- Controls: 1 x OLED Colour-display, 4 x Buttons, 2 x Jumper
- Power Supply: PoE (802.3af)

Article Reference

GGO-RDX



WPX Wall Panel Station

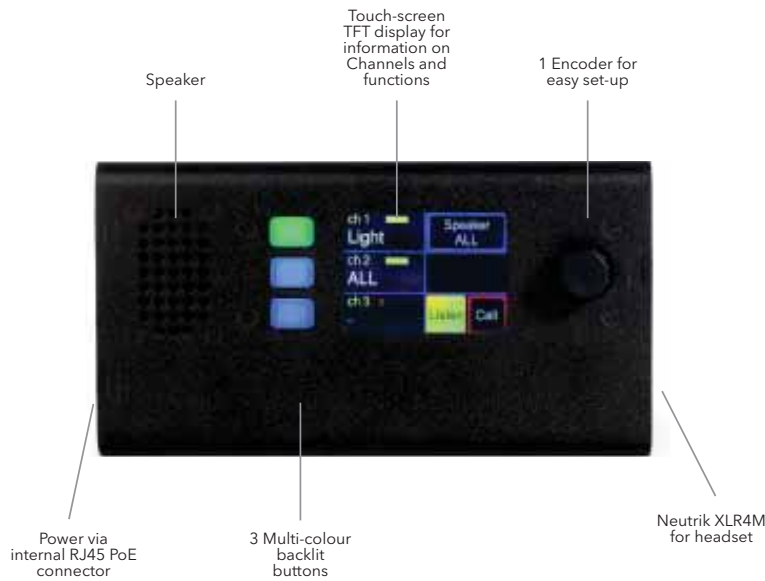

The Green-GO Wall Panel X Speaker version is a panel-mounted version of the Green-GO Beltpack with direct access to three communication Channels (either a single direct user or a group.) In addition there is a speaker with a separate engine to which any user or group can be assigned. For example program audio and stage manager announcements.

The Wall Panel X has a large colour TFT touch display which also acts as a cue acknowledgement button. The display will show textual information and coloured pop-ups for cue's and calls. On the front of the Wall Panel is a rotary encoder which acts as a master volume control for the speaker and when pressed allows for setup of the device. Together with 3 RGB backlit push buttons for direct talk access to the headset channels.

Features

- Easily combinable with any other Green-GO Beltpack or Multi-channel Station (no separate matrix or interface required)
- Integrated loudspeaker, or external loudspeaker
- Powered through PoE (802.3af-2003 Standard)
- Intercom routing data, system setup & preferences are stored in local memory
- Create your own configuration with the free Green-GO Control software

Technical Data

- Dimensions: 81 x 30 x 81 mm
- Weight: 480g
- Connections: Neutrik XLR4M
- Controls: 1 x Rotary Encoder
- Power Supply: PoE (802.3af)

Article Reference

GGO-WPX

Accessory

GHSA05



GHSA05 Handset Telephone Style

BEACON Signal Light

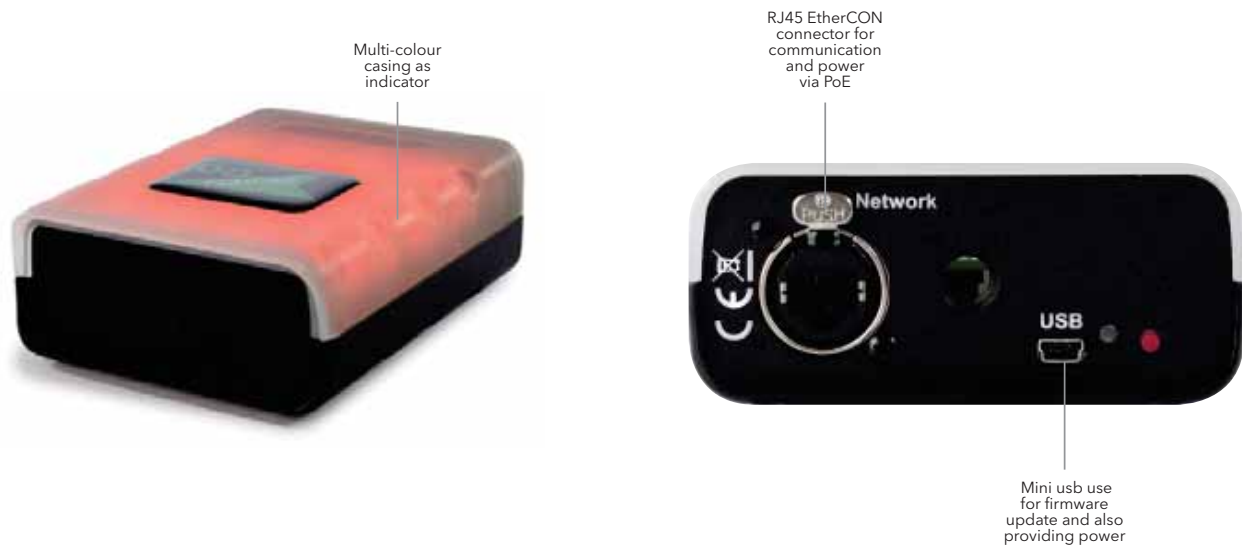

The BEACON signal light comes in the standard backpack format and serves as an optical indicator for incoming communications, either a call, or a warning/go cue indication. In addition, the BEACON signal light can also be used as a blue luminous passing light.

Configuration can be achieved simply and quickly on the device itself. Copying the system configuration and pairing the BEACON signal light with a user or group is also possible, via the red button on the rear of the unit.

Technical Data

- Dimension: 95mm x 119mm x 42mm
- Weight: 235g
- Connections: 1 x 10/100Mbps Neutrik RJ45 EtherCON, 1 x Mini usb
- Controls: 1 x Button, 1 x LED- Status Indicator
- Power Supply: PoE (802.3af)
- SupaClamp 16 mm x 3/8" Spigot

Article Reference

GGO-BEACON

InterfaceX 2-wire and 4-wire



The InterfaceX links 2-wire or 4-wire analogue intercom systems into the Green-GO digital Ethernet network. This audio in/out interface with contact closures connects to an existing matrix or other analogue interfacing products. A 4-wire intercom can be connected to the dual in/out 3-pin XLR ports. This allows two separate audio signals (or a stereo signal) to be injected into the Green-GO network and transmitted to any other location on the same Ethernet network. Next to the 4-wire connections, there is a separate 3-pin XLR port dedicated to connecting a basic analogue 2-wire intercom (partyline system). All of the ports can be configured individually through the setup menu of the Green-GO InterfaceX. There are also two GPIO connectors provided on the back of the device.

2-Wire Section Features

- Connects analogue 2-wire ring/party-line systems to the Green-GO digital network.
- Support for DC, AC or AC/DC call signals.

4-Wire Section Features

- Connects analogue 4-wire intercom systems or analogue audio signals to the Green-GO digital Network.

Technical Data

- Dimensions: 485 x 150 x 45 mm
- Weight: 2.4 kg
- Connections: 2 x 10/100Mbps Neutrik RJ45 EtherCON, Connections (2-Draht): 1 x Neutrik XLR3F, Connections (4-Draht): 2 x Neutrik XLR3F, 2 x Neutrik XLR3M, 2 x SUB-D9
- Controls: 1 x Matrix-Dot-Display, 1 x Rotary Encoder, 220Ω Terminator
- Power Supply: PoE (802.3af) or optional external 12V DC Power Supply

Article Reference

GGO- InterfaceX

Q4WR Quad 4-wire Interface



The Quad 4 wire interface can connect any 4-wire analogue system into the Green-GO digital Ethernet network.

A 4-wire port consists of a pair of 3-pin XLR in and output ports with a Sub-D9 connector for general purpose in and output for contact closures.

This allows separate audio signals to be injected into and extracted from the Green-GO network. All ports can be configured individually through the setup menu of the Quad 4 wire.

A 4-wire port can operate in a full user based mode or a general purpose line in/out mode. The Quad 4-wire interface has a large TFT color screen for easy and quick setup and menu navigation. The display will give a quick overview of transmitted and received audio signals and levels. The general purpose in and outputs can be setup to send and receive calls or cues or to activate channels

Features

- Easily combinable with any other Green-GO Beltpack or Multi-Channel Station (no separate matrix or interface required)
- Connect any 4-wire device, for example a third party 4-wire intercom matrix.
- Get Audio into and out of the Green-GO system, like Program audio or announcements.
- Connect an audio source from anywhere in the world with a Green-GO bridge device.
- Intercom routing data, system setup & preferences are stored in local memory
- Create your own configuration with the free Green-GO Control software

Technical Data

- Dimensions: 485 x 150 x 45 mm
- Weight: 2,45 kg
- Connections: 2 x 10/100Mbps Neutrik RJ45 EtherCON, 4 x Neutrik XLR3F, 4 x Neutrik XLR3M, 4 x SUB-D9
- Controls: 1 x 2,2" TFT screen
- , 1 x Rotary Encoder
- Power Supply: PoE (802.3af) or optional external 12V DC Power Supply

Article Reference

GGO- Q4WR

DNTI Dante Interface



The Dante interface links up to 8 audio streams from and into the Green-GO network. The Dante interface will directly convert digital audio streams from Dante or AES67 to Green-GO and vice-versa, without the conversion losses that occur during analog to digital (and contrary) conversion.

This allows various audio signals to be injected into and extracted from the Green-GO network. All ports can be configured individually through the setup menu of the Dante Interface. The Dante ports are manageable with the Dante Controller.

Each of the 4 dual ports can operate in a full user based mode or a general purpose line in/out mode

The Dante interface has a large TFT color screen for easy and quick setup and menu navigation. The display will give a quick overview of transmitted and received audio signals and levels.

Features

- Easily combinable with any other Green-GO Beltpack or Multi-Channel Station (no separate matrix or interface required)
- Connects up to 8 Dante/AES67 audio streams to and from the Green-GO network
- Get Audio into and out of the Green-GO system, like Program audio or announcements.
- Connect an audio source from anywhere in the world with a Green-GO bridge device.
- Intercom routing data, system setup & preferences are stored in local memory
- Create your own configuration with the free Green-GO Control software

Technical Data

- Dimensions: 485 x 150 x 45 mm
- Weight: 2,38 kg
- Connections: 4 x 10/100Mbps Neutrik RJ45 EtherCON
- Controls: 1 x 2,2" TFT screen
- , 1 x Rotary Encoder
- Power Supply: PoE (802.3af) or optional external 12V DC Power Supply

Article Reference

GGO- DNTI

SI4W 4-Wire Slim interface



The 4W Slim Audio Interface links any 4-wire analogue intercom system into the Green-GO digital Ethernet network. This audio in/out interface connects either to an existing matrix or other analogue interfacing products. This allows an audio signal to be injected into the Green-GO network and transmitted to any other location on the same Ethernet network. When use as a matrix style intercom system, one channel of the matrix system can be used as a group on the Green-GO systems

Technical Data

- Dimension: 95mm x 119mm x 42mm
- Weight: 235g
- Connections: 1 x 10/100Mbps Neutrik RJ45
- EtherCON 1x XLR3F, 1x XLR3M
- Controls: 1-display, 4 x Buttons
- Power Supply: PoE (802.3af)

Article Reference

GGO-SI4W

SI2W 2-Wire Slim interface

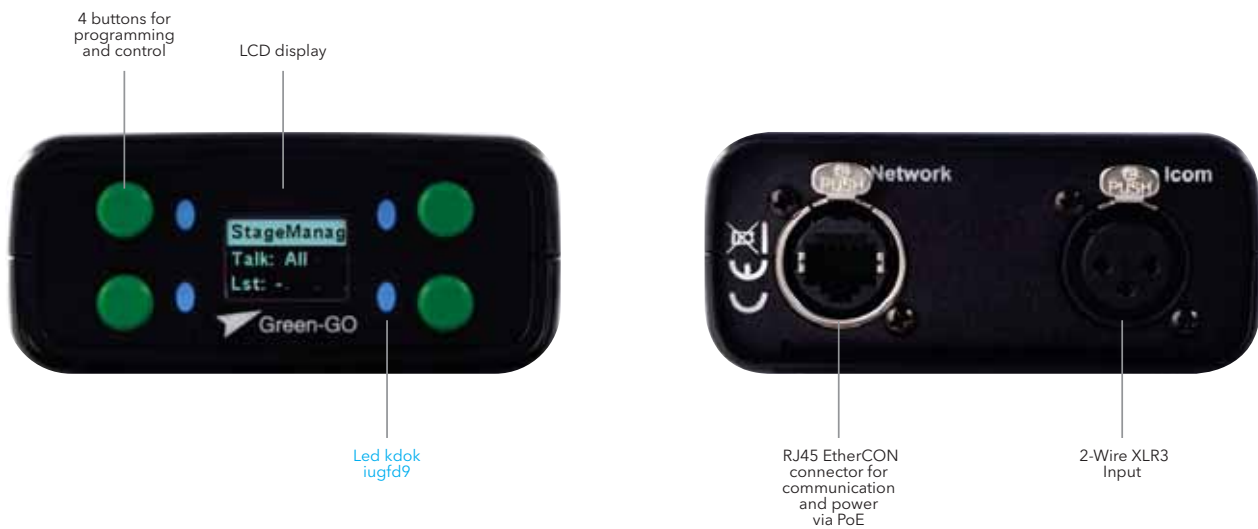

The 2W Slim Audio Interface links 2-wire analogue intercom systems into the Green-GO digital Ethernet network. The 3-pin XLR port will connect to the partyline system. The port can be configured through the setup menu. One of the channels on the partyline system then becomes a group on the Green-GO system.

Technical Data

- Dimension: 95mm x 119mm x 42mm
- Weight: 235g
- Connections: 1 x 10/100Mbps Neutrik RJ45
- EtherCON 1x XLR3F
- Controls: 1-display, 4 x Buttons
- Power Supply: PoE (802.3af)

Article Reference

GGO-SI2W

BRIDGEX Network Interface



The Green-GO BridgeX provides (4) UDP network ports, intended to connect remote locations to a Green-GO network. This can be done in two separate modes; 'Bridge' mode or 'Remote User' mode. In both modes, the Green-GO BridgeX can support four connections.

In 'Bridge' mode, the BridgeX will connect two Green-GO networks together through a separate network or the internet. The audio (and optionally call) signals will be transported from one Green-GO network to the other. This setup will create one group that is spread over two sites. The group ID and name of these two sites do not need to match.

The BridgeX can also be configured to enable remote users. A Green-GO device in a remote location can connect to a LAN port of the BridgeX through the internet - when set to Remote Connection mode - and simply becomes another user in the system. In addition, a port can be used to connect an iOS device through a wireless access point connected to the bridge to provide an auxiliary wireless user. Each of the four UDP ports on the bridge can be configured for any of the three options - remote group, remote user, or wireless iOS user.

Technical Data

- Dimensions: 485 x 150 x 45 mm
- Weight: 2.35 kg
- Connections: 4 x 10/100Mbps Neutrik RJ45 EtherCON, Controls: 1 x Matrix-Dot-Display, 1 x Rotary Encoder
- Power Supply: PoE (802.3af) or optional external 12V DC Power Supply

Article Reference

GGO-BRIDGEX

Green-Go iPhone App



The iPhone App turns the iPhone into a full wireless belt-pack. Until now, it was necessary to create a network connection via Cat cable, however the new iPhone app offers the opportunity to move freely regardless of where the next switch is.

All that is needed is the new bridge interface and a wireless access point. Four iPhones can be integrated into the system per bridge system.

DLS18GBx Network Switch

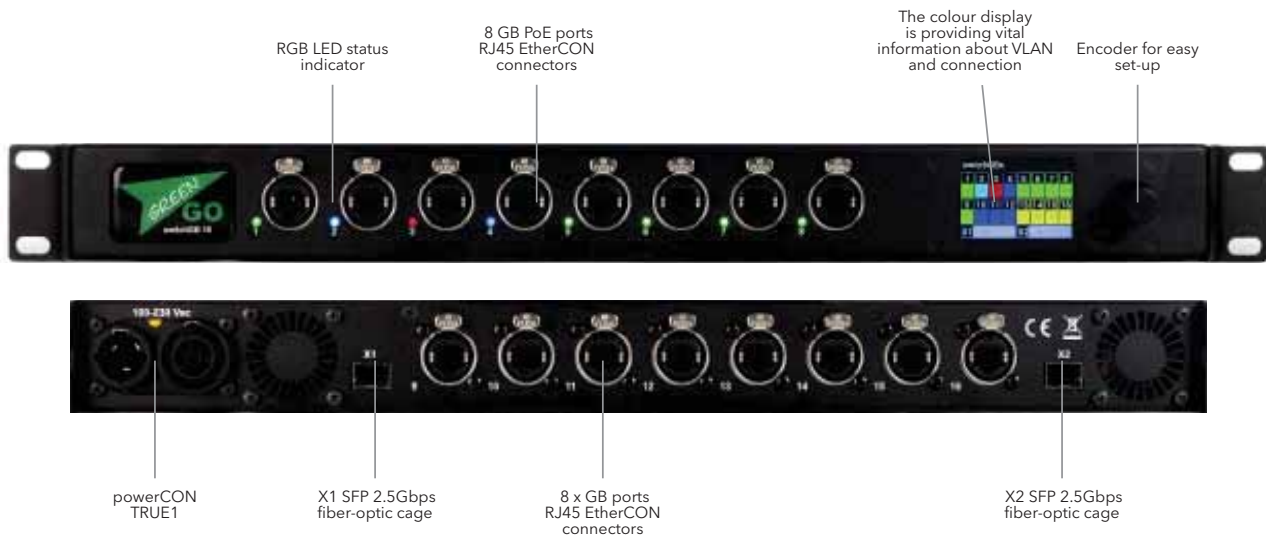

Green-GO switches form the backbone of the network distribution system. The Green-GO switchGBx 18 has been specifically designed for live entertainment applications where a mixture of data protocols would overload and saturate commercially-available network switches.

The switchGBX 18 allows you to effortlessly set up VLAN trunking through fast redundant loops. It's very easy to create virtual networks that can communicate with each other through a trunking connection - thus allowing traffic to and from devices on different networks. By creating a loop between two or multiple devices, the Green-GO switchGBX 18 completely eliminates delays and device redundancy. If a connection between two devices is broken, it will be bypassed through a different route in the configuration because every device is part of a loop.

The Green-GO switchGBx 18 features 16 Ethernet ports with speeds up to 1GB and 2 SFP cages for fiber-optic capable of speeds up to 2.5Gbps. The Ethernet ports on the front panel support PoE and have RGB LED status indicators.

Technical Data

- Dimensions: 485 x 150 x 45 mm
- Weight: 2.5kg
- Connections (Front): 8 GB PoE RJ45 EtherCON
- Connections (Rear): 8 x GB RJ45 EtherCON
- Controls: 1 x TFT Colour Display, 1 x Rotary Encoder
- Power Supply: powerCON TRUE 1 100-230V AC

Article Reference

GGO-SW18GBX

SW8.1 Network switch



The Green-GO switch 8.1 has been designed specifically for integrating a Green-GO communications system into an existing Ethernet network, and to provide a Power Over Ethernet supply to Green-GO outstations.

This professional-standard Ethernet switch has eight 10/100Mbps Power over Ethernet ports on the front and an additional Ethernet port on the back. The Switch 8.1 is housed in a single 19 rack unit and uses a powerful processor to avoid network slowdown and data crashes. The Green-GO Switch 8.1 is silent as the design does not require a ventilation fan.

Technical Data

- Dimensions: 485 x 150 x 45mm
- Weight: 2kg
- Connections (Front): 8
10/100Mbps PoE RJ45 EtherCON
- Connections (Rear): 1 x
10/100Mbps RJ45 EtherCON
- Power Supply: powerCON TRUE1
100-230V AC

Article Reference

GGO-SW8.1

Control Software

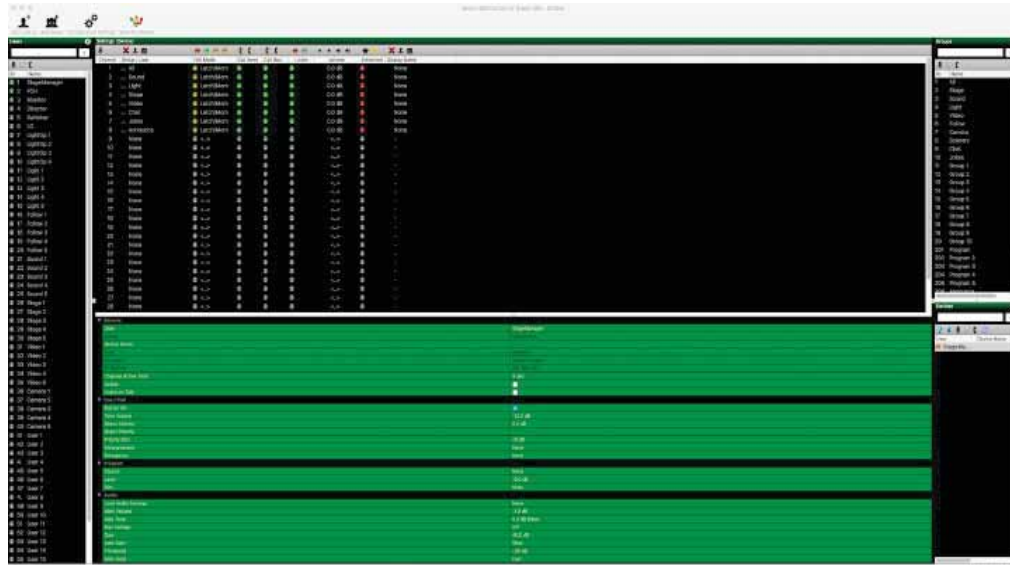

This software can be used to create and edit your system configurations. It can be used to program groups, users, channels and general settings, as well as display all devices available on the network. . You can add up to 250 Groups and 3000 Users and configure all the 32 channels every device can process. You can create a new configuration or download an existing one from a connected device.

Text messages can also be sent in real time. The Green-GO configuration software is free for all users and can be easily downloaded by emailing support@greengocom.com.

The software is available for both PC and Mac.

HS-200S Single over ear headset

Green-GO
Digital Intercom

This headset will provide the perfect sound quality and comfort that every user of our Green-GO belt packs shall expect. Lightweight but still isolating you from the external noise, the impedance of the speakers and the sensitivity of the microphone is perfectly matched to our system. Fitted with an original Neutrik® 4pins connector, the coiled cable can extend from 1meter to 3meters.

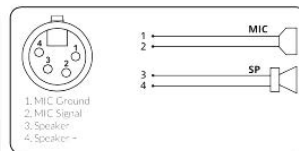

Headphone specifications:

Frequency range: 10Hz to 22kHz
Nominal impedance : 200 Ohm
T.H.D. : 0.2%
Nominal power: 100mW

Microphone specifications:

Polar pattern: Unidirectional
Frequency range: 100Hz to 12 kHz
Nominal impedance: 150 Ohm

Physical:

Weight: 335g
Size: 210x170x100mm

Product code: GGO-HS200S

HS-200D Dual over ear headset

Green-GO
Digital Intercom

This headset will provide the perfect sound quality and comfort that every user of our Green-GO backpacks shall expect. Lightweight but still isolating you from the external noise, the impedance of the speakers and the sensitivity of the microphone is perfectly matched to our system. Fitted with an original Neutrik® 4pins connector, the coiled cable can extend from 1meter to 3meters.

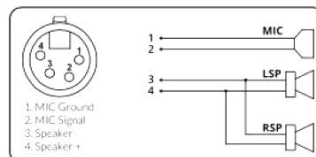

Headphone specifications:

Frequency range: 10Hz to 22kHz
Nominal impedance : 200 Ohm
T.H.D. : 0.2%
Nominal power: 100mW

Microphone specifications:

Polar pattern: Unidirectional
Frequency range: 100Hz to 12 kHz
Nominal impedance: 150 Ohm

Physical:

Weight: 430g
Size: 210x170x100mm

Product code: GGO-HS200D

GMH D9400

Professional heavy duty Communications Headsets



The 9.000 headset series is especially developed for live & studio performances, sporting events and other events where a high audio quality, reliability and comfort are very important.

Major benefits of this product are:

- heavy duty design
- over average sound performance (high-end 400 Ohm drivers and high end microphones)
- rotatable microphone boom with integrated switch in end position
- good wearing comfort
- good cancellation of exterior noise
- high material and production quality
- reliability
- customizable
- OEM customers are welcome
- each assembled part also available as separate spare
- high-end studio version with changeable real condenser microphone capsules in different polar pattern available

The headset features either a dynamic microphone with cardioids pattern or a studio-electret microphone with hyper-cardioids pattern for excellent front-to-back ratios and an assembled pop filter for minimizing disturbing noise. The dual muff version comes with two ear cups and a bendable microphone boom. You can choose between several different wires and connectors. The drivers are high-end 400 Ohm drivers for high audio quality.

Specifications:

- Acoustical Design: closed
- Ear Pad Design: oval-aural
- Continuous Power Rating: 50mW (100mW D version)
- Cable: 1,8m plurethane, black
- Connector: 4 pin XLR (Female)
- Average Pressing force: 6N
- Weight w:o cable: appr. 180gr. (280gr D version)
- Warranty: 2 years

GMH D9400 S



GMH D9400 D



Headphone:

- Driver Principle: dynamic
- Nominal Impedance: 400 ohm (2x 400ohm D version)
- Frequency Response: 40 – 14.400 Hz
- External Noise Isolation: appr. 16 dBA (22dBA D version)

Microphone

- Type: dynamic
- Nominal Impedance: 200 ohm
- Frequency Response: 40 – 15.000 Hz
- Polar Pattern: cardioids





WE NEED TO TALK!

Audio Visual Lighting bvba

D'Helst 21 - 9280 Lebbeke - Belgium

Tel. +32-(0)52-412924 - Fax +32-(0)52-412530

E-mail: info@avl.be

www.avl.be - www.chamsys.be

VISIT US @ greengodigital.com

Green-GO is designed and manufactured in the Netherlands by ELC Lighting

Worldwide Sales: Anima Network Ltd Rue le Praz 48 CH-1903 Collonges

Sales@anima.network + 4179 210 4613